

**RFQ for Professional Architectural and Engineering Design Services for  
Construction of a New City Hall and Police Station Expansion**

**Responses to RFQ Questions  
Updated January 19, 2018**

- Has the geotechnical work already been completed for the projects in this posting?  
The existing Police Station and Mountlake Terrace Library buildings are on top of pilings. The existing Police Station was built in the early 1990s and needs to be upgraded, per international UBC on seismic.

There were some existing conditions and restoration plans done by Aecom in 2009. Please see below, the full-size PDF can be viewed at: [www.cityofmlt.com/1922/Civic-Campus-Project](http://www.cityofmlt.com/1922/Civic-Campus-Project).

**Conceptual Grading and Restoration Plan (11.05.09)**

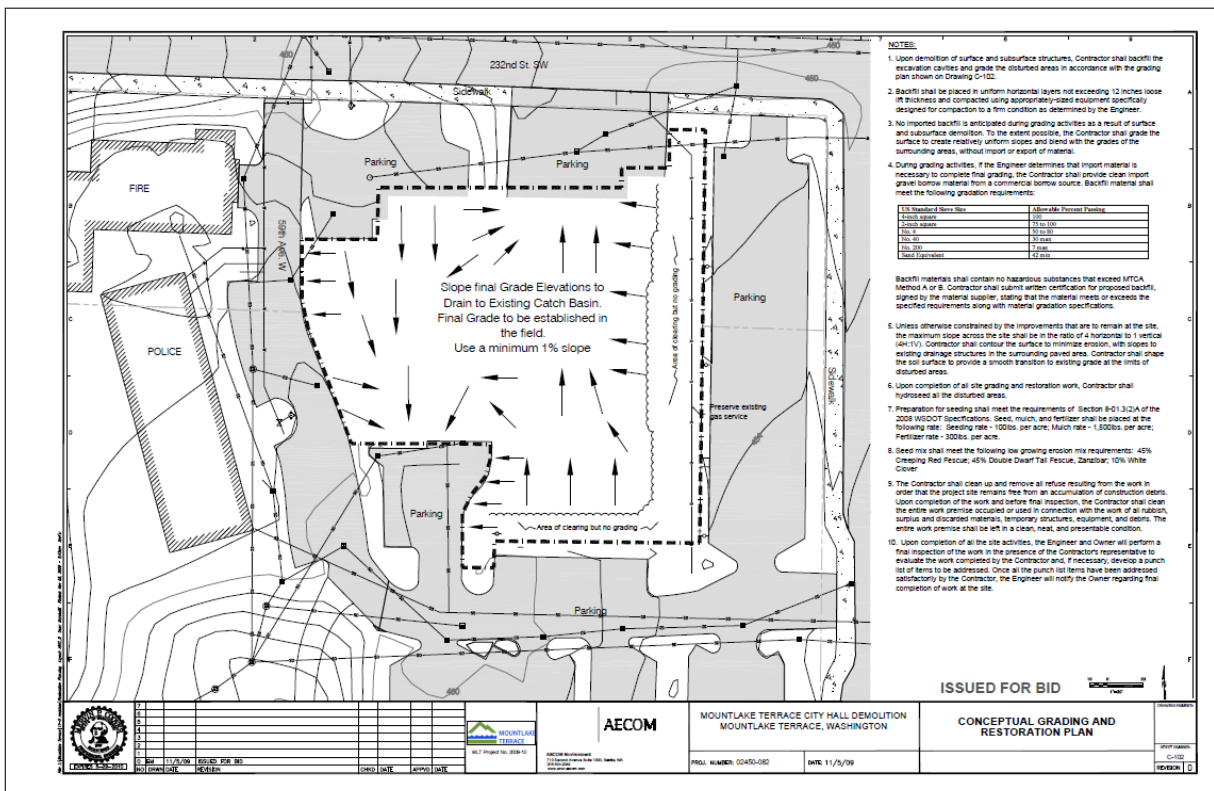

- Concerning the page length of the RFQ. On page 5 of the RFQ, it is noted that “the Statement of Qualifications shall be no more than fifteen (15) pages in length.” The exceptions are noted as the following: covers, Letter of Interest, section dividers. Does this mean that you will be counting resume pages as well?

Yes, but in lieu of resumes you can include a summary of professional qualifications to save space.