

## Unincorporated Islands/Potential Annexation Areas

There are 9 unincorporated areas within or abutting the City limits, which are areas of potential annexation. The following table (Table LU-4) provides information regarding the size of each of these and the existing land uses.

**Table LU-4**

**UNINCORPORATED AREAS/ISLANDS**  
As of January 2003

<b>Unincorporated Islands</b>	<b>Number of Parcels</b>	<b>Number of Acres</b>	<b>Current Use</b>
Island A	6	1.7	SFR
Island B	1	0.4	SFR
Island C	2	0.38	SFR
Island D	2	0.42	SFR
Island E	1	0.15	SFR
Island F	3	1.5	SFR/Vacant/COM
Island G	2	3.17	SFR/Vacant
Island H	1	1.62	SFR
Area I	11	26.17	SFR/Church/ Vacant
<b>Total</b>	<b>29</b>	<b>35.51</b>	

Source: City of Mountlake Terrace, Planning Department

The location of each of the areas is shown on the following map, Figure LU-2. Together, the 9 islands total 35.51 acres and contain 29 individual parcels. The existing land use is primarily single-family residential. Islands F, G, and I include vacant land. Island F also contains a commercial use.

**Figure LU-2**

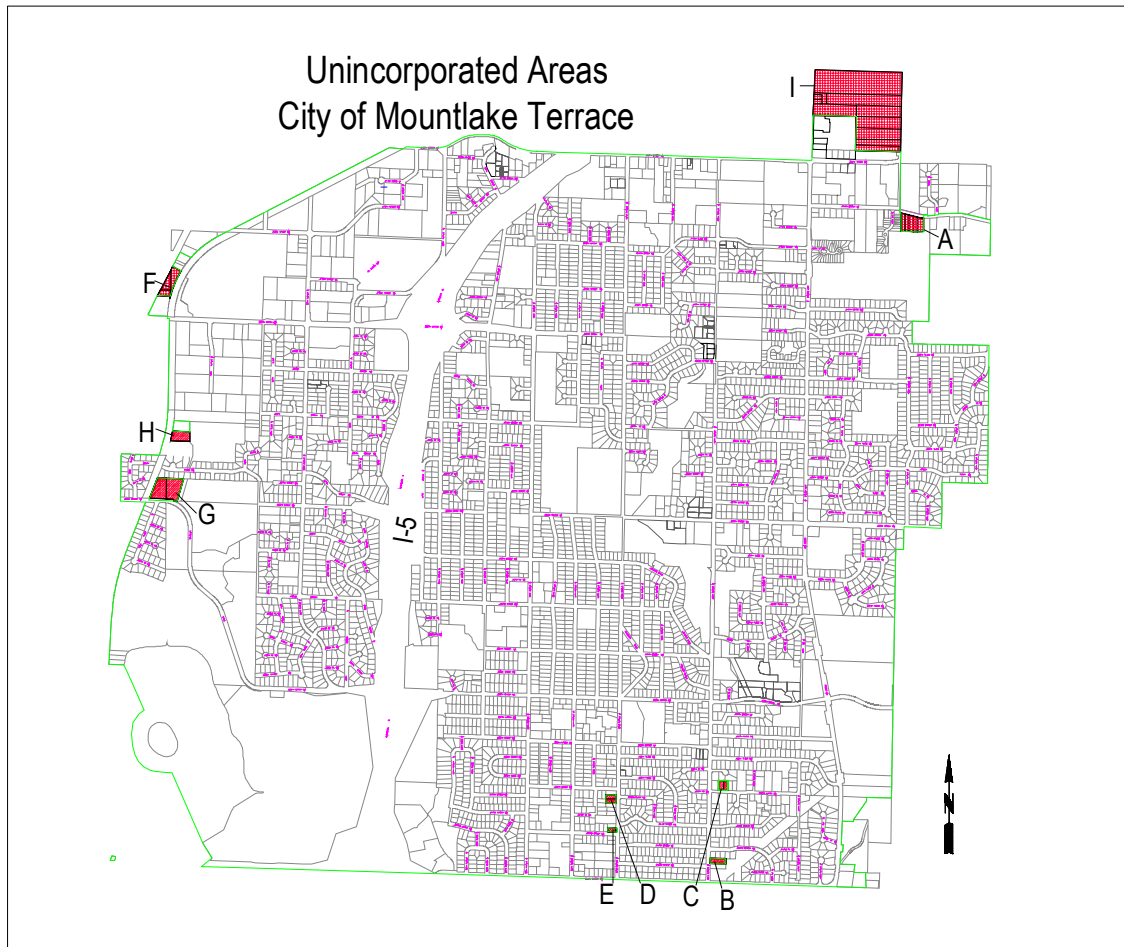

Area I is the largest area available for annexation by the City and is mostly vacant. Some land is occupied by a church and residential uses. The northern portion of the area contains wetlands. The church is currently served by an on-site septic system. The City has the capability to provide sewer service to portions of the area. Agreement with the City of Lynnwood is required for Mountlake Terrace to annex this area. Such agreement is required per "Settlement Agreement in Regard to Lynnwood vs. Boundary Review Board" dated 1997.