



MOUNTLAKE TERRACE

23204 58th Avenue West, Mountlake
Terrace, WA 98043
425-744-6267, FAX 425-778-6421

Garage (Separation) 2003 IRC, Section R309

WHEN REQUIRED: when there is a wall and/or ceiling directly separating garage and living areas.

WHAT IS REQUIRED: One - hour fire resistive construction at ceilings and walls including fire protection at door and duct.

ENVELOPE

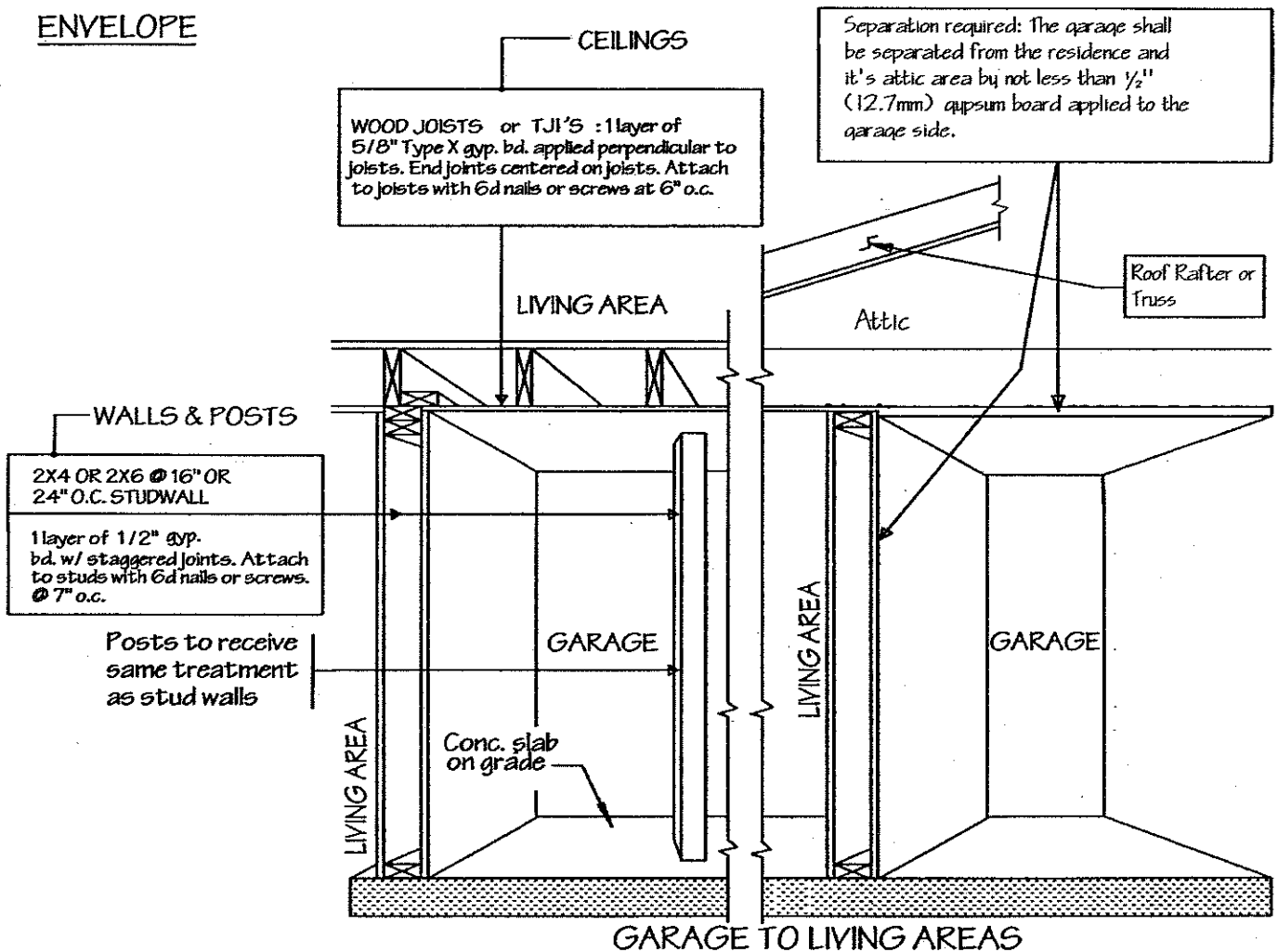

NOTE:

All fasteners must be gyp. bd. type and fastened to joists or studs unless otherwise noted.

All screws must be TYPE W. or TYPE S. and must penetrate wood not less than 5/8"

GENERAL INFORMATION:

1. CONSULT WITH THE PLANNING DIVISION REGARDING REQUIRED SETBACKS AND MINIMUM PARKING REQUIREMENTS.
2. OBTAIN A BUILDING PERMIT BEFORE COMMENCING CONSTRUCTION.
3. THE INTENT OF THIS BULLETION IS TO ADDRESS THE BASICS OF PRIVATE RESIDENTIAL GARAGES ONLY AND DOES NOT ADDRESS THE SUBJECT IN GREAT DETAIL. IT DOES NOT SUPERCEDE ADOPTED CODE REQUIREMENTS. ADDITIONAL INFORMATION MAY BE AVAILABLE FROM THE CITY BUILDING DEPARTMENT, A HOME IMPROVEMENT STORE OR THE LIBRARY.



MOUNTLAKE TERRACE

23204 58th Avenue West, Mountlake
Terrace, WA 98043
425-744-6267, FAX 425-778-6421

Garage (Separation)

PENETRATIONS (of the protected envelope)

DUCTS

Ducts inside of protected space must be a min. of 26 gauge sheet metal w/ no register outlets into the garage.

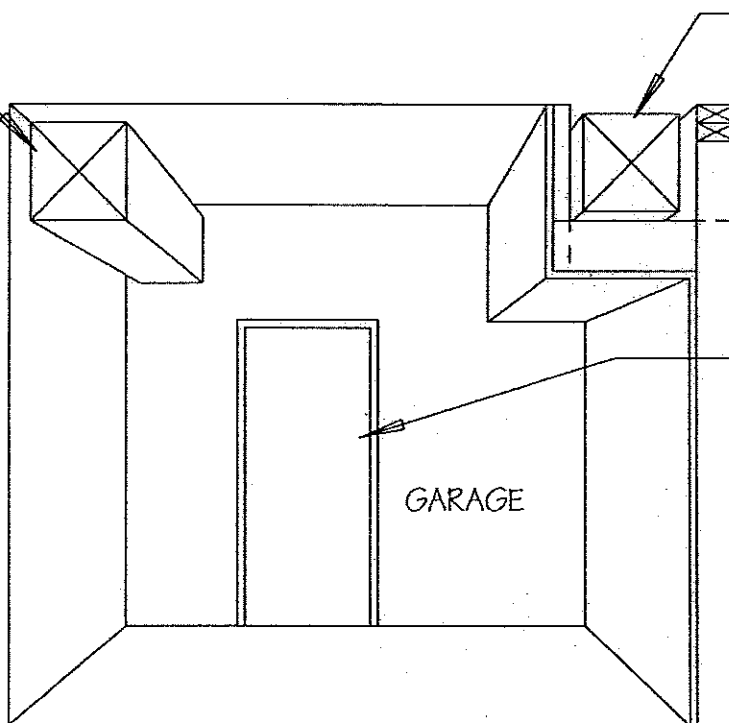

Ducts outside the protected envelope are excluded from these regulations.

DOORS

Doors separating garage and living spaces shall be solid wood or honeycomb core steel 1-3/8" thick (or 20min. fire rated doors)

GENERAL INFORMATION:

1. CONSULT WITH THE PLANNING DIVISION REGARDING REQUIRED SETBACKS AND MINIMUM PARKING REQUIREMENTS.
2. OBTAIN A BUILDING PERMIT BEFORE COMMENCING CONSTRUCTION.
3. THE INTENT OF THIS BULLETION IS TO ADDRESS THE BASICS OF PRIVATE RESIDENTIAL GARAGES ONLY AND DOES NOT ADDRESS THE SUBJECT IN GREAT DETAIL. IT DOES NOT SUPERCEDE ADOPTED CODE REQUIREMENTS. ADDITIONAL INFORMATION MAY BE AVAILABLE FROM THE CITY BUILDING DEPARTMENT, A HOME IMPROVEMENT STORE OR THE LIBRARY.



**MOUNTLAKE
TERRACE**

23204 58th Avenue West, Mountlake
Terrace, WA 98043
425-744-6267, FAX 425-778-6421

Garage (Separation)

SPECIAL CONDITIONS (of the protected envelope)

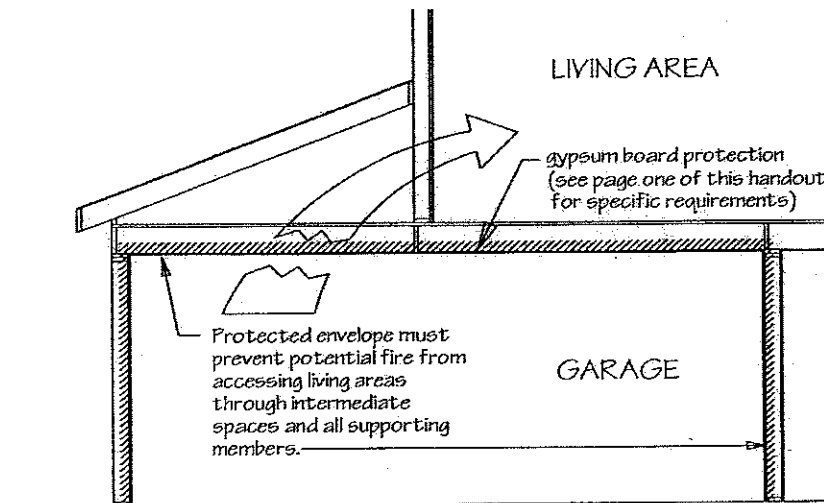

OR

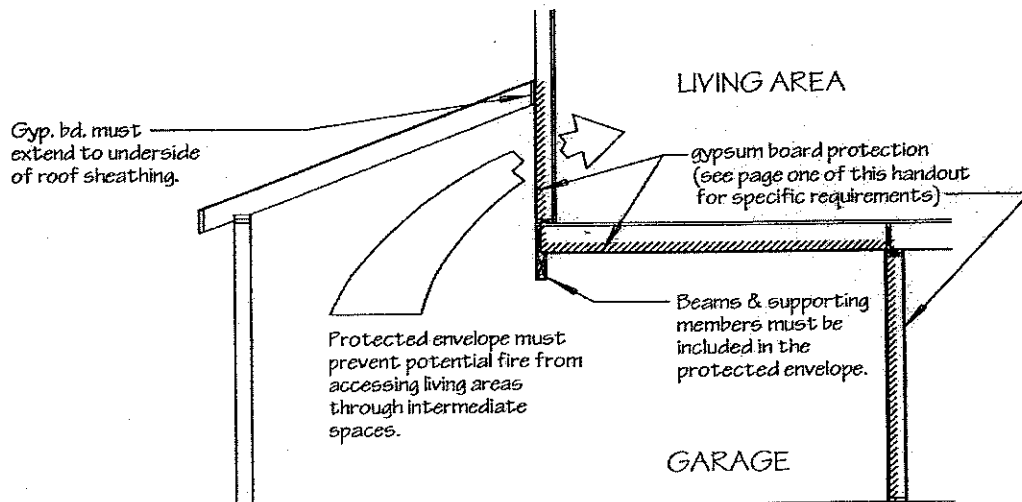

GENERAL INFORMATION:

1. CONSULT WITH THE PLANNING DIVISION REGARDING REQUIRED SETBACKS AND MINIMUM PARKING REQUIREMENTS.
2. OBTAIN A BUILDING PERMIT BEFORE COMMENCING CONSTRUCTION.
3. THE INTENT OF THIS BULLETIN IS TO ADDRESS THE BASICS OF PRIVATE RESIDENTIAL GARAGES ONLY AND DOES NOT ADDRESS THE SUBJECT IN GREAT DETAIL. IT DOES NOT SUPERCEDE ADOPTED CODE REQUIREMENTS. ADDITIONAL INFORMATION MAY BE AVAILABLE FROM THE CITY BUILDING DEPARTMENT, A HOME IMPROVEMENT STORE OR THE LIBRARY.